

FOR LEASE/SALE



Vantage Point Corporate Center

2181 East Aurora Rd., Twinsburg, OH 44087

Mac Biggar

Vantage Point Corporate Center

2181 East Aurora Rd., Twinsburg, OH 44087

PROPERTY INFORMATION

- Great highway access
- Well maintained buildings
- Could be subdivided
- Classy office setting

SPACE

- Entire property available for sale: \$3,995,000
- Lease rate \$9.95 PSF, triple net
- Multiple buildings available for sale and lease, together or individually
- 10,000 to 50,500 SF available



Mac Biggar • macbiggar@hannacre.com • 216.839.2020



Vantage Point Corporate Center

2181 East Aurora Rd., Twinsburg, OH 44087



TOTAL POPULATION

90,350

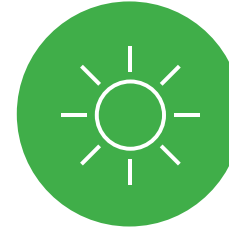

TOTAL DAYTIME POPULATION

51,131



AVG. HH INCOME

\$151,473

2023 Population Summary

	1 Mile	3 Miles	5 Miles
Total Population	4,168	35,235	90,350
Households	1,781	13,829	35,784
Daytime Population	4,273	23,058	51,131

2023 Household Income

	1 Mile	3 Miles	5 Miles
Average Income	\$126,359	\$154,006	\$151,473
Median Income	\$71,743	\$106,822	\$109,353

Vantage Point Corporate Center

2181 East Aurora Rd., Twinsburg, OH 44087

BUILDING A

- Size: 15,500 SF
- Parking: 63 spots
- Asking Price: \$1,229,000
- Lease Rate: \$9.95 per SF, minimum of 10,000 SF
- Built in 2012

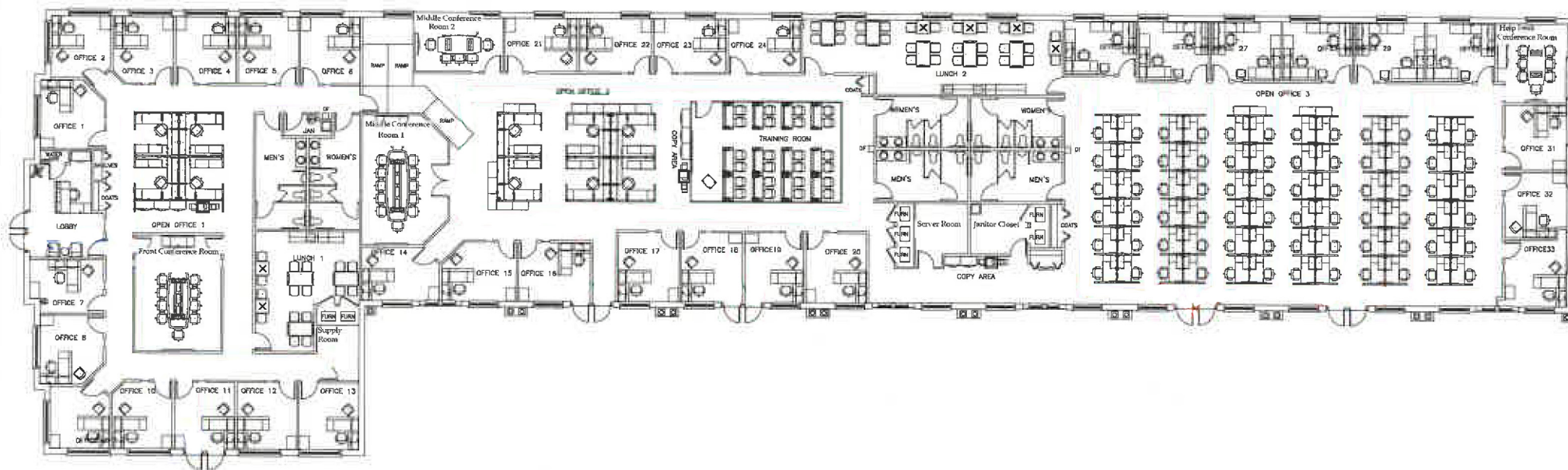

Mac Biggar • macbiggar@hannacre.com • 216.839.2020



Vantage Point Corporate Center

2181 East Aurora Rd., Twinsburg, OH 44087

BUILDING B

- Size: 17,500 SF
- Parking: 85 spots
- Asking Price: \$1,395,000
- Lease Rate: \$9.95 per SF, minimum of 10,000 SF
- Built in 2001

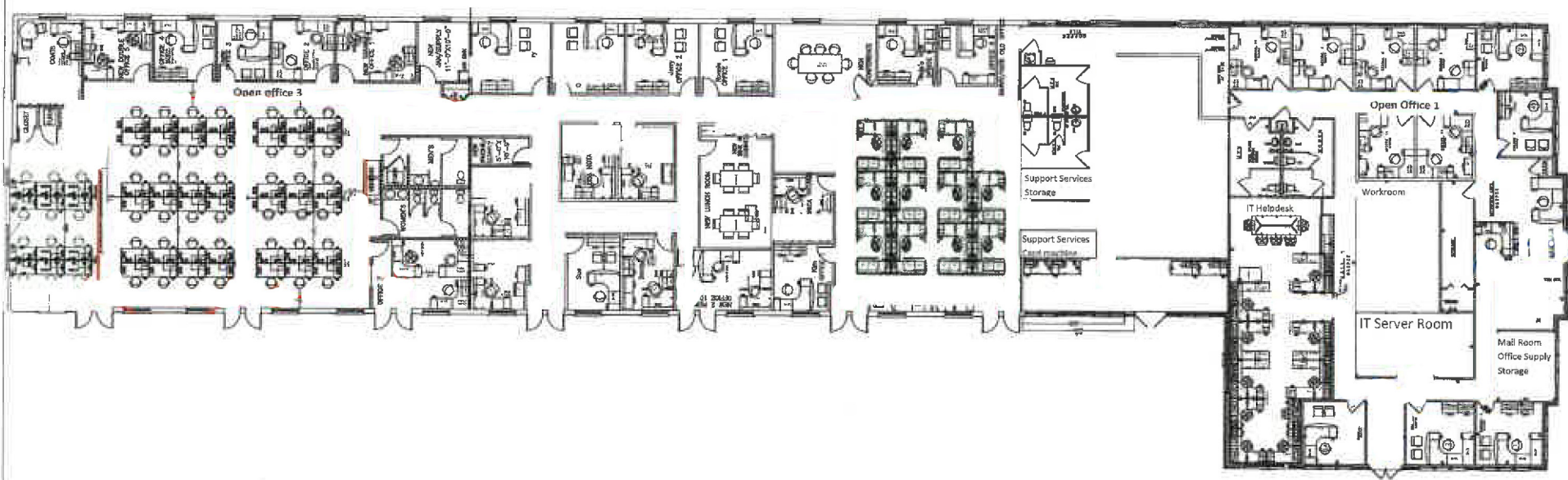

Vantage Point Corporate Center

2181 East Aurora Rd., Twinsburg, OH 44087

BUILDING C

- Size: 17,500 SF
- Parking: 62 spots
- Asking Price: \$1,395,000
- Lease Rate: \$9.95 per SF, minimum of 10,000 SF
- Built in 2012

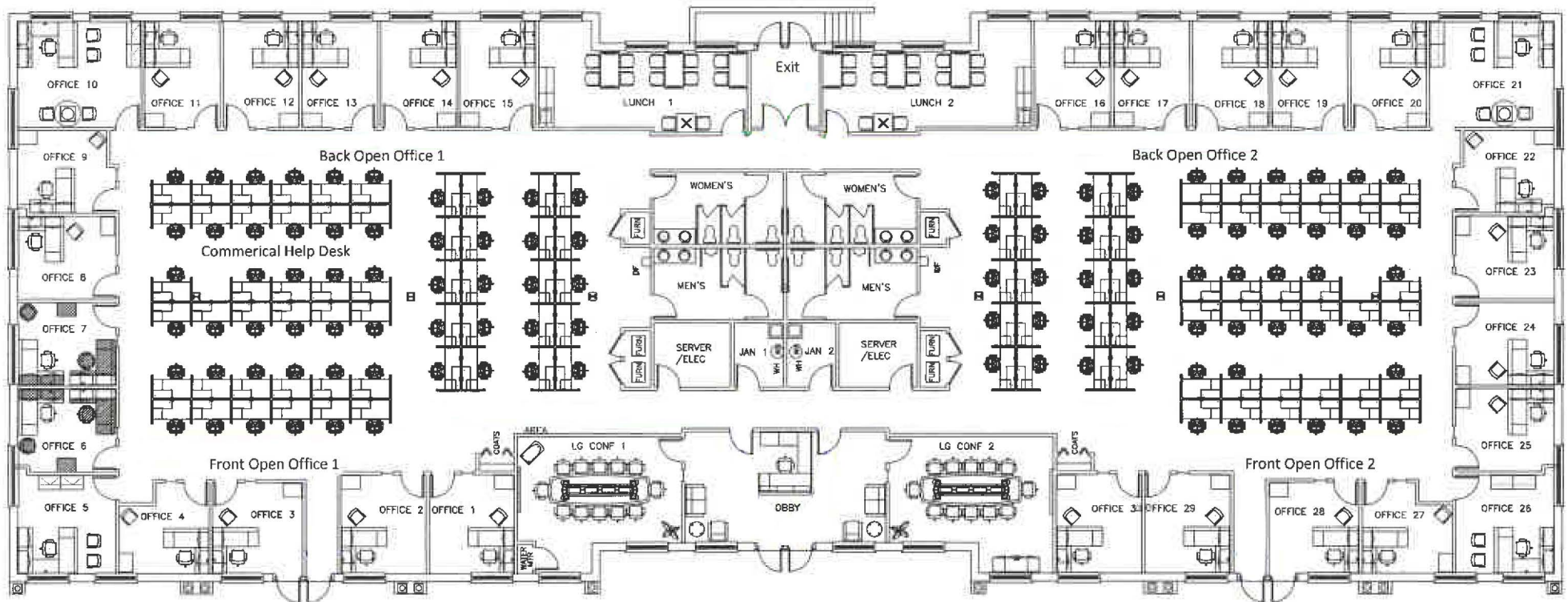

Mac Biggar • macbiggar@hannacre.com • 216.839.2020



Vantage Point Corporate Center

2181 East Aurora Rd., Twinsburg, OH 44087



Mac Biggar • macbiggar@hannacre.com • 216.839.2020